



Our lightest  
touch yet.

The ResMed AirTouch™ N30i



Live life in high Res



AirTouch™  
N30i

# Meet the ResMed AirTouch™ N30i

Introducing the ResMed AirTouch™ N30i, an exceptionally comfortable tube-up nasal mask. The ComfiSoft™ cushion combines the reliable seal and durability of silicone with the natural comfort only fabric can bring. Both the cushion and the flexible SpringFit™ frame contour to the shape of the face and nose, and are designed to make compliance more achievable.



## Fabric-wrapped SpringFit™ frame

The self-adjusting silicone tubular frame is fully wrapped in super soft, breathable, moisture-wicking fabric that's light, gentle on the face and keeps skin cool.

Available in two sizes and designed to easily adjust to different facial profiles and head shapes.

## Fabric and silicone seal technology

Designed to maximise comfort without compromising seal performance.

## ComfiSoft™ cushion

Fabric fused with silicone creates a cushion seal that's soft, breathable and moisture-wicking.

## Nasal cradle design

Available in three sizes to cover 97% fit range.<sup>1</sup> The curved design contours to the patient's nose for a secure and comfortable seal all night.

## Quick-release elbow

Allows patients to easily disconnect and reconnect mask from tubing.

## Tube-up mask design

Keeps tubing out of the way allowing freedom to sleep in any position.

## Easy-to-adjust headgear

Shaped to sit comfortably at the back of the head ① with side tabs ② ③ designed to get the fit just right.

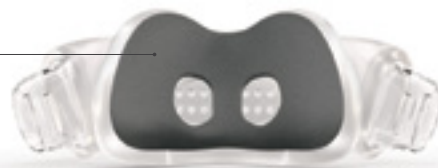

Cushion back

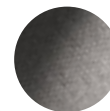

## Cushion innovation

Soft fabric covers nearly all of the nasal area for ultimate skin comfort.

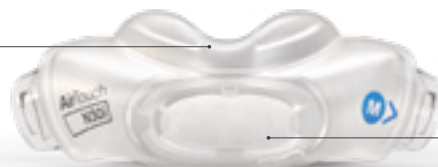

Cushion front

## QuietAir™ diffused vent

Designed to be quieter than a whisper while minimising breeze for both patients and bed partners.

### Complete mask system

62302 (STD)  
62303 (SML)

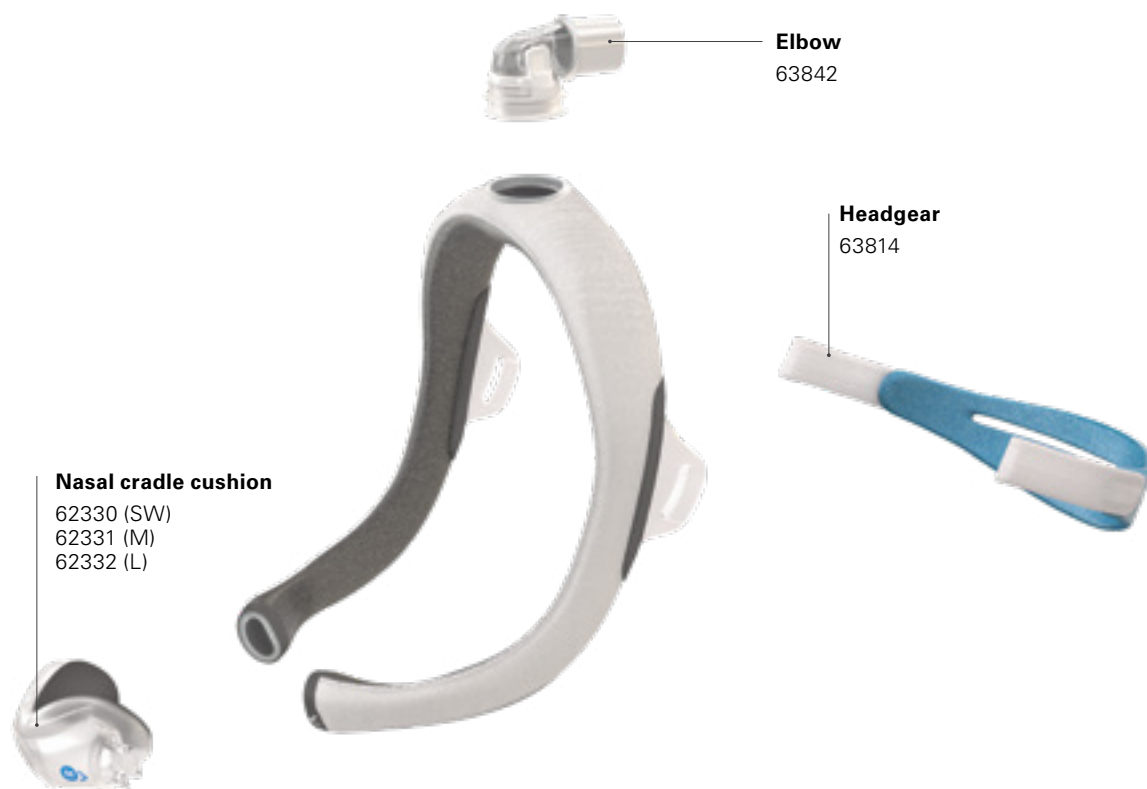

### Nasal cradle cushion

62330 (SW)  
62331 (M)  
62332 (L)

Elbow  
63842

Headgear  
63814

Fabric-wrapped SpringFit frame with elbow  
62328 (STD), 62329 (SML)

## AirTouch™ N30i

### Complete mask system

(includes mask frame, nasal cushion and headgear)

Product name	Product code
AirTouch N30i STD STPK APAC	62302
Includes: AirTouch N30i standard frame and headgear	
Cushions: SW, M	
AirTouch N30i SML STPK APAC	62303
Includes: AirTouch N30i small frame and headgear	
Cushions: SW, M	

### Nasal cradle cushion

Product name	Product code
AirTouch N30i Cushion – SW	62330
AirTouch N30i Cushion – M	62331
AirTouch N30i Cushion – L	62332

### Fabric-wrapped SpringFit frame with elbow

Product name	Product code
AirTouch N30i Frame with Elbow - STD	62328
AirTouch N30i Frame with Elbow - SML	62329

### Accessories

Product name	Product code
30i Elbow	63842
N30i/P30i Headgear	63814
N30i/P30i QuietAir Vent	63889
N30i/P30i Multi-Hold Vent	63888

Live life in high Res





AirTouch™ **N30i**



## How to fit the AirTouch N30i

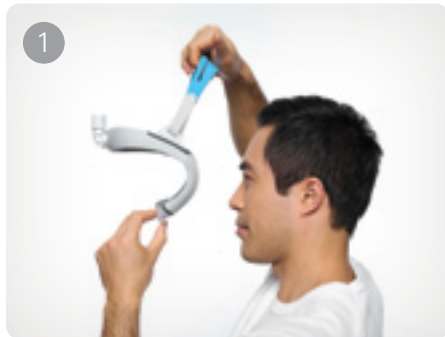

1 Pull the frame and headgear over the head so the elbow sits on top and the headgear is positioned behind the head.



2 Place the cushion under the nose. Tighten or loosen the headgear until the cushion fits comfortably.

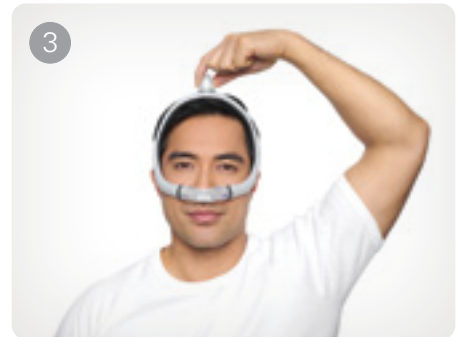

3 Squeeze the side buttons on the elbow and detach it from the frame.

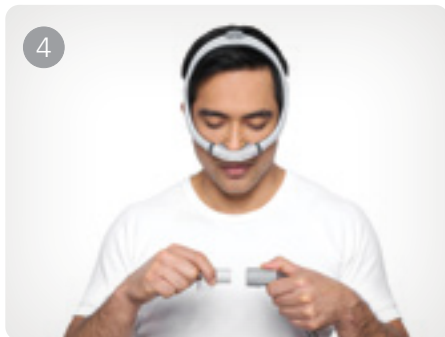

4 Connect the air tubing from the device to the elbow.



5 Reattach the elbow to the frame. The mask is now ready to use.



Wear longer hair over the top of the headgear for the best fit.

Refer to the user guide for further instructions and complete labelling information, including indications, contraindications, warnings and precautions.

## Experience the ResMed AirTouch N30i today.

With a flexible, fabric-wrapped frame and our innovative ComfiSoft™ nasal cushion, ResMed's AirTouch N30i nasal mask is designed to bring your patients a more natural sleeping experience. By the sleep apnea brand most trusted by sleep physicians in the US.<sup>2</sup>



Scan the QR code or contact your ResMed sales representative to get going.



<sup>1</sup> ResMed AirTouch N30i demonstrated a 97.2% fit range based on acceptable seal and comfort after 90 days of use. (refer to RMO\_WSN\_73).

<sup>2</sup> ResMed study of board certified sleep physicians in the U.S. Study conducted August 12–September 6, 2022. n=200

**ALWAYS READ THE LABEL AND FOLLOW THE INSTRUCTIONS FOR USE. You should speak to your doctor about your symptoms and whether a CPAP device is suitable for you.**



**ResMed Pty Ltd**  
1 Elizabeth Macarthur Drive  
Bella Vista NSW 2153 Australia

AirTouch, ComfiSoft, QuietAir, and SpringFit are trademarks of the ResMed family of companies. For patent and other intellectual property information, see [ResMed.com/ip](https://resmed.com/ip). © 2024 ResMed Pty Ltd. 10114250/1 2024-10

[ResMed.com/AirTouchN30i](https://resmed.com/AirTouchN30i)